

Product:

Front Load
Washing Machine
7.5kg

Model Code/s:

EFLW75

Esatto

User Manual

Exactly what you need

Version:

V2 0721

Online:

esatto.house

Residentia Group

—

Head Office

165 Barkly Avenue
Burnley, Victoria
Australia 3121

—

ACN

600 546 656

—

Online

residentia.group
www.esatto.house

  @esatto.house

—

Postage

PO Box 5177
Burnley, Victoria
Australia 3121

—

Telephone

1300 11 4357

Congratulations on purchasing your washing machine. The Esatto brand is proudly distributed within Australia by Residentia Group Pty Ltd.

Please refer to the warranty card at the rear of this manual for information regarding your product's parts and labour warranty, or visit us online at: www.residentia.group

At Residentia Group, we are customer obsessed and our Support Team are there to ensure you get the most out of your appliance. Should you want to learn more about your washing machine such as the various washing modes or importantly taking care of the appliance, our Support Team are here to help.

You can use our online Support Centre at anytime by visiting:
<http://support.residentia.group.com.au>

Or you can contact us via phone by dialing: 1300 11 HELP (4357).

It is important that you read through the following use and care manual thoroughly to familiarise yourself with the installation and operation requirements of your appliance to ensure optimum performance.

Again, thank you for choosing an Esatto appliance and we look forward to being of service to you.

Kind Regards,
The Residentia Team



Contents

02
Welcome

04
**Safety
Instructions**

05
**Your Esatto
Washing
Machine**

06
Installation

08
**Washing
Your Clothes**

10
**Quick Start
Guide**

11
Controls

12
**Operating Your
Washing Machine**

16
Maintenance

19
Troubleshooting

20
Technical Data

21
Appendix

23
**Purchase
Details**

24
**Warranty
Information**

Safety Instructions

- If the supply cord is damaged, it must be replaced by the manufacturer, its service agent or similarly qualified persons in order to avoid a hazard.
- The new hose-sets supplied with the appliance are to be used and that old hose-sets should not be reused.
- This washing machine is for indoor use only.
- The openings must not be obstructed by a carpet.
- This appliance is not intended for use by persons (including children) with reduced physical, sensory or mental capabilities, or lack of experience and knowledge, unless they have been given supervision or instruction concerning use of the appliance by a person responsible for their safety. Children should be supervised to ensure that they do not play with the appliance.
- Pull out its plug from the power socket before cleaning or maintenance.
- Make sure that all pockets are emptied.
- Sharp and rigid items such as coin, brooch, nail, screw or stone etc. may cause serious damages to this machine.
- Pull out its plug and cut off water supply after the operation.
- Please check whether the water inside the drum has been drained before opening its door. Please do not open the door if there is any water visible.
- Pets and kids may climb into the machine. Check the machine before every operation.
- Glass door may be very hot during the operation. Keep kids and pets far away from the machine during the operation.
- Take care that power voltage and frequency shall be identical to those of washing machine.
- Do not use any socket with rated current less than that of washing machine. Never disconnect the power plug with wet hands.
- To ensure your safety, power cord plug must be inserted into an earthed three-pole socket. Check carefully and make sure that your socket is properly and reliably earthed.
- Children of less than 3 years should be kept away unless continuously supervised.
- Kids should be supervised to ensure that they do not play with the machine.
- Packing materials may be dangerous to the kids. Please keep all packing materials (plastic bags, foams etc) far away from the kids.
- Washing machine shall not be installed in bath room or very wet rooms as well as in the rooms with explosive or caustic gases.
- Make sure that the water and electrical devices must be connected by a qualified technician in accordance with the manufacturer's instructions and local safety regulations.
- Before operating this machine, all packages and transport bolts must be removed. Otherwise, the washing machine may be seriously damaged while washing the clothes.
- Before washing the clothes at first time, the washing machine shall be operated in one round of the whole procedures without the clothes inside.
- The washing machine with single inlet valve only can be connected to the cold water supply. The washing machine with double inlet valves can be connected to the hot water and cold water supply.
- Your washing machine is only for home use and is only designed for the textiles suitable for machine washing.
- Flammable and explosive or toxic solvents are forbidden. Gasoline and alcohol etc. shall not be used as detergents. Please only select the detergents suitable for machine washing, especially for drum.
- Do not to wash carpets.
- Be careful of burning when washing machine drains hot washing water.
- Never refill the water by hand during washing.
- After the program is completed, Please wait for two minutes to open the door.
- Please remember to disconnect water and power supply immediately after the clothes are washed.
- Do not climb up and sit on top cover of the machine.
- Do not lean against machine door.
- Please do not close the door with excessive forces. If it is found difficult to close the door, please check if the excessive clothes are put in or distributed well.
- The household washing machine isn't intended to be built-in.

CAUTIONS DURING HANDLING MACHINE

- 1 Transport bolts shall be reinstalled to the machine by a specialized person.
- 2 The accumulated water shall be drained out of the machine.
- 3 Handle the machine carefully. Never hold each protruded part on the machine while lifting. Machine door can not be used as the handle during the conveyance.

NOTES ON DISPOSAL:

This product should not be disposed with other household wastes. To prevent possible harm to the environment or human health from uncontrolled waste disposal, recycle it responsibly to promote the sustainable reuse of material resources. To return your used device, please use the collection systems or contact the retailer where the product was purchased. They return and can take this product for environmental safe recycling.

Your Esatto Washing Machine

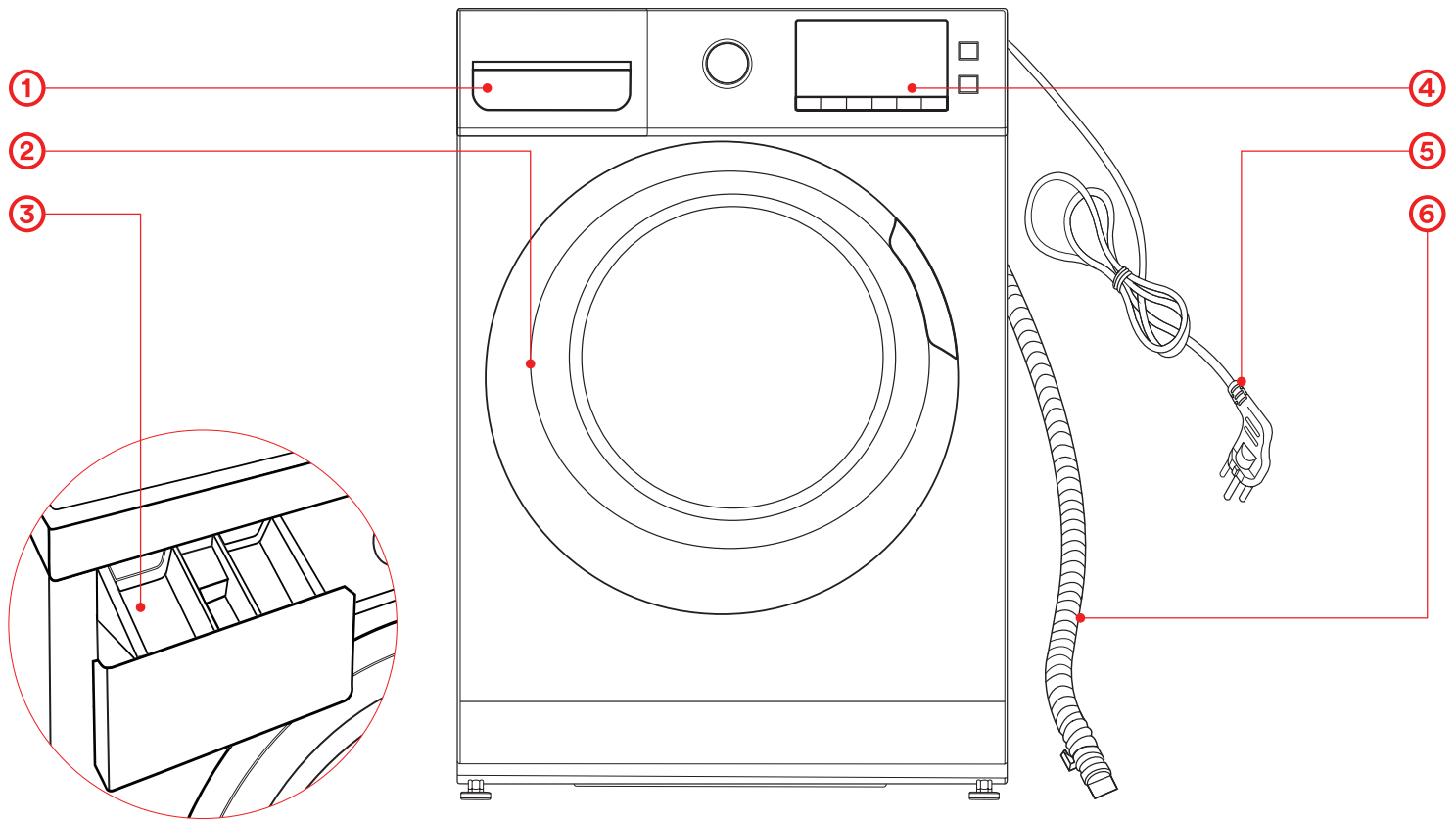

Component

- 1 Detergent Drawer
- 2 Door
- 3 Detergent Box
- 4 Control Panel
- 5 Power Plug
- 6 Outlet Hose

Accessories

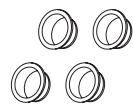

Transport hole plug



Hole plug (optional)

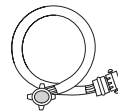

Inlet pipe, cold

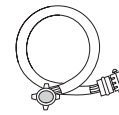

Inlet pipe, hot (optional)

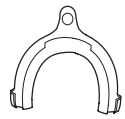

Outlet hose support (optional)

Installation

UNPACKING THE WASHING MACHINE

Unpack your washing machine and check if there is any damage during the transportation. Also make sure that all the items in the attached bag are received.

If there is any damage to the washing machine during the transportation, or any item is missing, please contact the local dealer immediately.

DISPOSE THE PACKING MATERIALS

The packing materials of this machine may be dangerous to kids. Please dispose them properly and avoid easy touch by kids. Please dispose the related packing materials according to the relevant local regulations. Please do not throw the packing materials away together with the other daily living rubbishes.

REMOVE TRANSPORT BOLTS

Before using this washing machine, transport bolts must be removed from the backside of this machine. Please take the following steps to remove the bolts:

1. Loosen all bolts with spanner and then remove them.
2. Stop the holes with transport hole plugs.
3. Keep the transport bolts properly for future use.

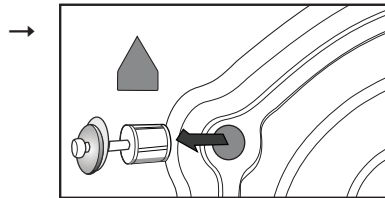

SELECT THE LOCATION

Before installing the washing machine, the location characterized as follows shall be selected:

- Rigid, dry, and level surface (if not level, please make it level with reference to the following figure "Adjust Leg")
- Avoid direct sunlight
- Sufficient ventilation
- Room temperature is above 0 C
- Keep far away from the heat resources such as coal or gas. Make sure that the washing machine will not stand on power cord.
- Do not install the washing machine on the carpet floor.

ADJUST LEG

1. When positioning the washing machine, please first check if the legs are closely attached to the cabinet. If not, please turn them to their original positions with hand or spanner and tighten the nuts with spanner.
2. After positioning the washing machine, press four corners on top cover of washing machine in sequence. If the washing machine is not stable when being pressed, this leg shall be adjusted.
3. Ensure the positioning status of washing machine. Loosen the lock nut with spanner and turn the leg with hand until it closely contacts with the floor. Press the leg with one hand and fasten the nut closely to the cabinet with the other hand.

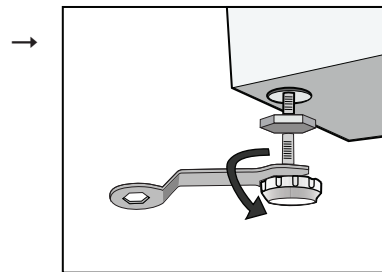

4. After being locked properly, press four corners again to make sure that they has been adjusted properly. If it is still unstable, it has to repeat Steps 2 and 3.
5. Put a solid cylinder (e.g. pop cans) oppositely on the top cover of the washing machine from in the left, right, front and back directions. If the cylinder keeps stable, the washing machine is positioned level. If it rolls, the washing machine is positioned unlevel. The rolling direction is the direction of lower ground surface. Then, the two legs in this direction shall be raised at the same time until the washing machine is level. Steps 1–3 are repeated to make the bottom legs closely against the ground and the nuts shall be locked tightly.

CONNECT INLET PIPE

Connect the inlet pipe as indicated in the figure. For the model which has hot valve, please connect the hot valve to hot water tap. Energy will decrease automatically for some program.

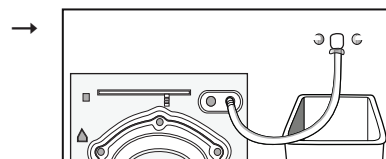

INSTALL INLET PIPE

1. Connect the elbow to tap and fasten it clockwise.
2. Connect the other end of inlet pipe to the inlet valve at the backside of washing machine and fasten the pipe tightly clockwise. Notes: after connection, if there is any leakage with hose, then repeat the steps to connect inlet pipe. The most common type of tap shall be used to supply water. If tap is square or too big, then standard tap shall be changed.

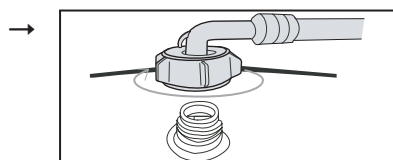

HOLE PLUG

This Hole plug is used to jam the hole on the back cabinet.

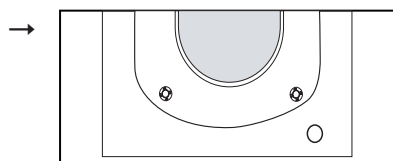

PLACE OUTLET HOSE

There are two ways to place the end of outlet hose:

1. Put it beside the water trough.

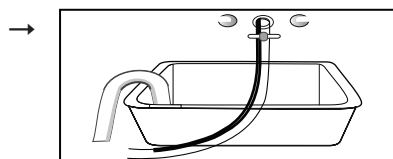

2. Connect it to the branch drain pipe of the trough.

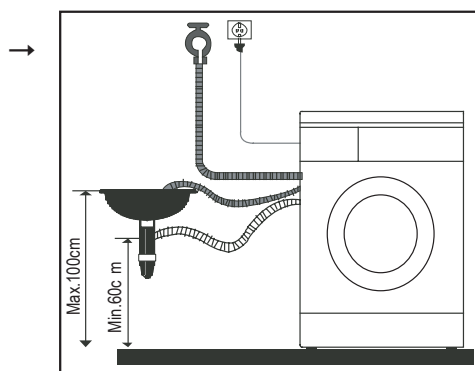

Position outlet hose properly so that the floor will not be damaged by water leakage.

NOTE:

If the machine has outlet hose support, please install it like the following pictures.

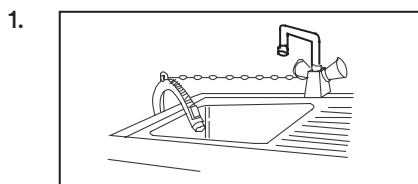

- When installing outlet hose, fix it properly with a rope.
- Position outlet hose properly so that the floor will not be damaged by water leakage.

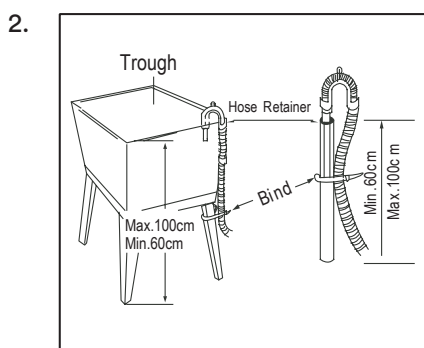

- If outlet hose is too long, do not force it into washing machine as it will cause abnormal noises.

ELECTRICAL CONNECTION

As the maximum current through the unit is 10A when you are using its heating function, please make sure the power supply system (current, power voltage and wire) at your home can meet the normal loading requirements of the electrical appliances.

- Please connect the power to a socket which is correctly installed and properly earthed.
- Make sure the power voltage at your place is same to that in the machine's rating label.
- Power plug must match the socket and cabinet must be properly and effectively earthed.
- Do not use multi-purpose plug or socket as extension cord.
- Do not connect and pull out plug with wet hand.
- When connecting and pulling out the plug, hold the plug tightly and then pull it out. Do not pull power cord forcibly.
- If power cord is damaged or has any sign of being broken, special power cord must be selected or purchased from its manufacturer or service center for replacement.

WARNING

1. This machine must be earthed properly. If there is any short circuit, earthing can reduce the danger of electrical shock. This machine is equipped with power cord, which includes plug, earthing wire at earthing terminal.
2. Washing machine shall be operated in a circuit separate from other electrical appliances. Otherwise, power protector may be tripped or fuse may be burned out.

Washing Your Clothes

CHECKLIST BEFORE WASHING CLOTHES

Please read this operation method carefully to avoid the troubles of washing machine and damages of clothes.

Check first if clothes will be damaged by detergent

Place your liquid detergent on a spare white towel and put this in contact with a hidden part of your colour clothing. Check if the towel takes on any of the colour.

- When washing scarves and other clothes that easily get decolorised, please wash them separately before washing.

KEEP IN MIND:

Never put the clothes to be washed in washing machine for a long period of time. Otherwise it may get moldy and cause spots. Therefore, please wash the clothes in time. The clothes also may get color changed or distorted if they are not washed according to the stated washing temperature. As for the stains on sleeves, collars and pockets, use the liquid detergent and wash it with a brush gently before washing.

CLOTHES THAT CANNOT BE WASHED

The clothes that may get distorted if being immersed in water or put through the washing machine cycle:

- Ties, waistcoats, western-style clothes, outer garments etc. may have obvious shrinkage if being immersed in water; the decolorized clothes such as blended spinning clothes of artificial fiber etc.
- Wrinkle-style clothes, embossed clothes, resin clothes etc. may get distorted when being immersed in water. Among cotton and wool materials, the clothes that get easily distorted are wrinkle-style silk, fur products and fur decorations;
- Clothes with decoration, long dress and traditional clothes etc are the products to get decolorized easily.
- Please do not wash the clothes without material labels and washing requirements.
- Never wash the clothes stained with the chemicals such as gasoline, petroleum, benzene, paint thinner and alcohol.

PLEASE PAY ATTENTION TO DETERGENTS

- “Low bubble” detergent or washing powder or washing powder special for drum washing machine shall be selected according to fiber types (cotton, synthetic fiber, soft products and wool products), colors, washing temperatures, dirty degrees and types. Otherwise, excessive bubbles may be generated and overflowed out of the drawer so that accidents may take place.
- Bleacher belongs to alkali type and can damage clothes, so it is suggested to use as little as possible.
- Powder detergents can easily leave the residues in the clothes so as to generate the bad smell, so they shall be sufficiently rinsed.
- Detergent can not easily get dissolved completely if there is too much detergent or water temperature is rather low. It can remain in clothes, pipes and washing machines to pollute the clothes.
- Washing shall follow the weight of clothes, dirty degrees, local water hardness as well as the recommendations from the detergent manufacturers. Please consult the water company if you are not clear of water hardness.

NOTES:

Keep detergents and additives in safe and dry places out of touch by kids.

PLEASE TAKE OUT THE ITEMS OUT OF THE POCKETS

Please check the pockets of the clothes to be washed, empty the rigid items such as decorations and coins, otherwise washing machine may be damaged or have abnormal troubles.

FOR THE CLOTHES TO BE WASHED, THEY ARE CLASSIFIED ACCORDING TO THE FOLLOWING CHARACTERISTICS:

The symbol types of care labels: the clothes to be washed are classified into cotton, blended fiber, synthetic fiber, silk, wool and artificial fiber.

- **COLOR** White and colorful colors shall be identified. All new colorful articles shall be washed in a separate way.
- **SIZE** the articles of different sizes are washed together to increase the washing effects.
- **SENSITIVITY** soft articles shall be washed separately. As for new pure wool textiles, curtains and silks, the soft washing procedure shall be selected. Check the labels in all washing articles.

The clothes shall be sorted before being put into washing machine. As for the curtains with hooks, the hooks shall be removed before being washed. The decorations on the clothes may damage the washing machine. As for the clothes with buttons or embroideries, they shall be turned over before being washed.

- **FASTENERS** Zips shall be zipped close and buttons or hooks shall be fixed. The loose band or ribbon shall be bound together.

It is suggested to put bras into the pillowslip with zip or buttons sealed to prevent the steel wire from popping out of bras into the drum and damaging the machine. Especially delicate textiles such as laced curtains, straight jackets, small articles (tight socks, handkerchiefs, ties etc.) shall be put into string bag for washing. When washing a single big and heavy dress such as Turkish towels, jeans, wadded jackets etc., it may easily cause great eccentricity and give alarm due to great unbalance. Therefore it is suggested to add one or two more clothes to be washed together so that draining can be done smoothly.

CLEAN AWAY DUSTS, STAINS AND PET HAIRS FROM THE CLOTHES.

The clothes may be damaged and disturb washing effects during the friction between dusts, stains and clothes.

TO PROTECT BABY SKIN

Baby articles (baby clothes and towels) including napkins shall be washed separately. If they are washed together with the adults' clothes, they may be infected. Rinsing times shall be increased to ensure the thorough rinsing and cleaning without the detergent residues.

NOTE:

It is suggested that the parts that are easily stained such as white sockets, collars and sleeves etc. shall be hand washed before being put into washing machine to achieve more ideal washing effects. Please use powder or liquid detergents. The residues of the soap could remain in the gaps of the clothes if soap is used.

CONFIRM THE WASHING CAPACITY

Do not put excessive washings; otherwise it may affect the washing effects. Please confirm the maximum affordable washing quantity according to the following table.

FIBER TYPE	MAX. LOADING CAPACITY (7.5KG)
Cotton	6.0kg
Synthetic	3.0kg
Wool	2.0kg
Delicate	2.5kg

The clothes which easily get fuzzed shall be turned over for washing. The clothes which easily get fuzzed shall be washed separately; otherwise the other articles can be stained with dust and thrum etc. Preferably, black clothes and cotton clothes shall be washed separately because they can easily get stained with the thrums of other colors when being washed together. Please check before washing.

WASHING MACHINE SHALL NOT WASH WATERPROOF MATERIALS (SKI SUITS, OUTSIDE NAPKIN PADS, CURTAINS).

As for the fiber products that water can not get soaked easily into such as water-proof cushions, and clothes, it is better not to wash. Otherwise there will be water bursting out or abnormal vibration to cause danger while rinsing and draining so that the clothes also may be damaged (such as outside napkin pads, raincoats, umbrella, ski suits, car covers, sleeping sacks etc.).

CAUTIONS DURING DRAINING

Draining of normal clothes: Moistures of washings are drained through drain hole. Draining of water-proof clothes and fiber products: In the normal washing and draining status, moistures of water-proof clothes and fiber products can not be drained while washing water is gathered in one direction so that the eccentricity of washing machine is too great and vibration or moving is caused.

Quick Start Guide

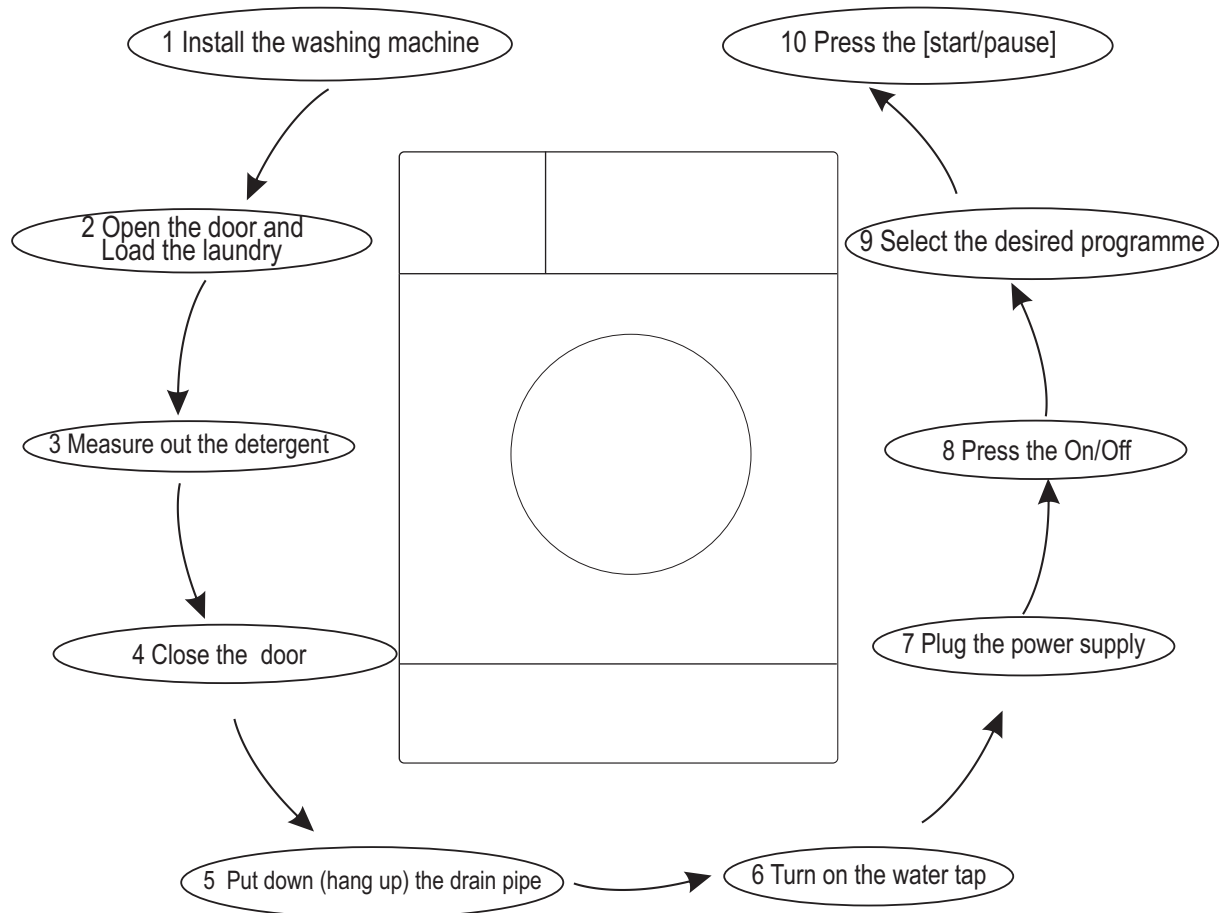

AFTER WASHING NOTES:

1. After washing, the washing machine will make the sound
2. Close the water tap;
3. Press the On/Off button and pull out the power plug.

Controls

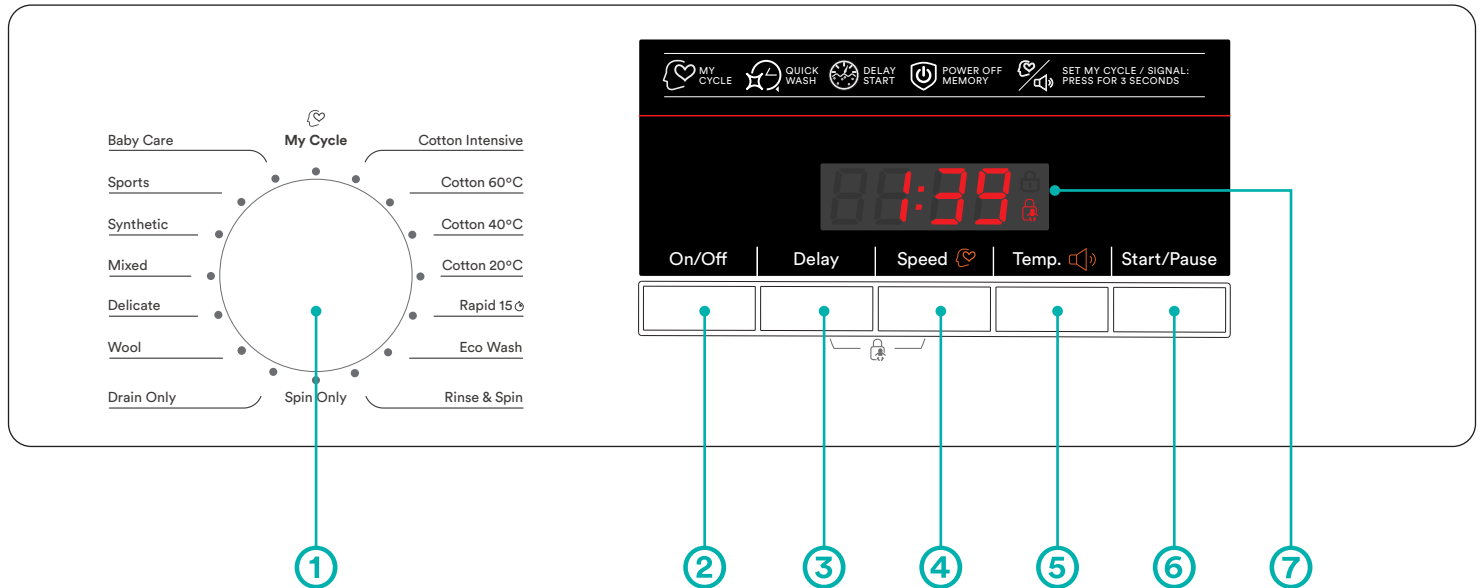

- KEY**
1. PROGRAM SELECTION KNOB
 2. ON/OFF BUTTON
 3. DELAY BUTTON
 4. SPEED BUTTON
 5. TEMPERATURE BUTTON
 6. START/PAUSE BUTTON
 7. LED SCREEN DISPLAY

1. PROGRAM SELECTION KNOB
There are 16 types of washing selection functions in display. For example:
 - Cotton intensive: With the corresponding temperature selections: 20, 30, 40, 60, 90° C, Cold
 - Cotton 60° C; Cotton 40° C; Cotton 20° C;
 - Quick 15': 20, 30, 40° C, Cold
 - Eco Wash : 20, 30, 40° C, Cold
 - Rinse & Spin
 - Spin only
 - Drain only
 - Wool: 20, 30, 40° C, Cold
 - Delicate: 20, 30° C, Cold
 - Mixed: 20, 30, 40° C, Cold
 - Synthetic: 20, 30, 40, 60° C, Cold
 - Sports: 20, 30, 40° C, Cold
 - Baby care: 20, 30, 40, 60, 90° C, Cold
 - My Cycle: customised program of your choosing

NOTES:

1. The Control panel line chart is for reference only. Please refer to real product as standard.
2. The Control panel could be changed without written notice. Please visit the website of Washing Machine or call up the service line for consultation.

Operating Your Washing Machine

■ Washing Clothes at first time

Before washing clothes at first time, the washing machine shall be operated in one round of the whole procedures without clothes in as follows:

1. Connect power source and water.
2. Put a little detergent into the box and close it.
3. Press the button "On/Off".
4. Press the button "Start/Pause".

The drawer is separated as follows:

I: Pre-detergent or washing powder.

II: Main detergent

☼ : Washing additive, such as fabric softener or tackifier.

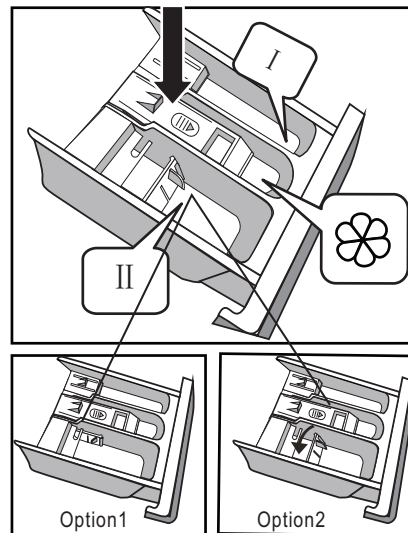

■ Put detergent into washing machine.

1. Pull out the drawer.
 2. Fill pre-detergent into Case I (when necessary).
 3. Fill detergent into Case II.
- option 1: detergent (powder) . option 2(liquid)
4. Fill softener into Case ☼ (when necessary).

Notes:

- As for the agglomerated or ropy detergent or additive, before they are poured into the detergent box, it is suggested to use some water for dilution to prevent the inlet of detergent box from being blocked and overflowing while filling water.
- Please choose suitable type of detergent for the various washing temperature to get the best washing effect with less water and energy consumption.

■ Start up washing machine

Connect the power. Check if water pipes are connected properly. Open the tap completely. Put in the clothes to be washed and fill in the detergent and tackifier. Then press the button "On/Off", Select the proper procedures and functions and press the button "Start/Pause".

■ Select the procedure

The proper washing procedures shall be selected according to the types, quantities, and dirtiness of the clothes to be washed in combination with the following washing temperature table.

90 °C	Seriously besmirched, pure white cotton or flax (for example: coffee table cloths, canteen table cloths, towels, bed sheets)
60 °C	Moderately besmirched, colorful flax, cotton and synthetic articles with certain decolorizing degree (for example: shirts, night pajamas; Slightly besmirched, pure white flax
40 °C, 30 °C, 20 °C, Cold water	Normally besmirched articles (for example: synthetic and wool)

First, turn the rotary switch to select the corresponding procedures according to the types of textiles.

Second, select the proper temperature according to the dirtiness. Generally, the higher the temperature is, the more the power is consumed.

Last, select the proper revolution speed. The higher the revolution speed is, the drier the textiles are spun, but higher the noises will also be increased.

The surfaces of delicate textiles will have wrinkles and the working life of washing machine will be shortened.

PLEASE NOTE: to protect the clothes, the lower revolution speed shall be selected for delicate textiles. The main washing procedures depend on the types of the clothes to be washed as follows:

- Cotton

You can select this procedure to wash the daily washable clothes. The washing period is quite long with quite strong washing intension. It is recommended to wash the daily cotton articles, for example: bed sheets, quilt covers, pillowcases, gowns, underwear etc.

- Cotton 60/40 °C

You can select this procedure to wash the daily clothes. The washing period is quite long with quite strong washing intension. The temperature is default is 60 °C / 40 °C.

- Express 15'

This procedure is suitable for washing few and not very dirty with 15'.

- Rapid 45'

This procedure is suitable for washing few and not very dirty clothes quickly.

- ECO 60'

As for few light dirty clothes, the maximum temperature of washing is limited to 30 °C , and saving more energy.

- Baby Care

You can select this procedure to wash your baby's clothes, it can make the baby's wear cleaner and make the rinse performance better to protect the baby skin.

- Sports

You can select this procedure to wash the activewear.

- Synthetic

You can select this procedure to wash the quite delicate clothes. The procedure is shorter compared with that for cottons and the washing intension is quite gentle. It is recommended to wash synthetic articles, for example: shirts, coats, blending. As for curtains and laced textiles, the procedure "Synthetic" shall be selected. While washing the knitting textiles, detergent quantity shall be reduced due to its loose string construction and easily forming bubbles.

- Mixed

You can select this procedure wash the tough clothes, that need much more time and strength. It is used for the daily clothes fo cotton, such as sheets, chained, pillowcases bathrobe and underwear.

- Delicate

You can select this procedure to wash your delicate clothes. Its washing intension is gentler and revolution speed is less compared with the procedure "Synthetic". It is recommended for the articles to be washed softly.

- Wool

You can select this procedure to wash the wool textiles labeled with "Machine Wash". Please select the proper washing temperature according to the label on the articles to be washed. Furthermore, the proper detergent shall be selected for wool textiles.

- Drain Only

Separate Drain only Procedure.

- Spin Only

Separate spin only procedure. Soap water or rinse water shall be drained out before spinning.

- Rinse&Spin

Separate Rinse&Spin Procedure.

- My Cycle

Press Speed 3sec. for my cycle to memory the procedure. The default my cycle is cotton.

The main function can be selected as follows:**- Delay**

Delay function can be set with this button, the delaying time is 0-24H.

Set the delay function:

1. Select a programme;
2. Press the Delay button to choose the time;
3. Press Start/Pause to commence the Delay operation.

Cancel the Delay function : Press the Delay button until the display will be 0H . It should be pressed before starting the program. If the program already started, should press the On/Off button.

Notes: If there is any break in the power supply while the machine is operating, a special memory stores the selected programme and when the power is restarted ,press the Start/Pause button the left time is continues.

- Child Lock

To avoid that the washing procedure cannot operate normally due to the mis operation by kids during the washing procedure, you can select this function, In this case, the other buttons except On/Off button can not work, at this state ,the machine power off when press the key on/off. The machine remembers the program child lock and the program during powered off when press the key on/off again.

Press "Temp" and "Speed" together 3 seconds during the running procedure, the buzzer will beep ,Start/Pause button as well as the rotary switch are locked. Press the two buttons for 3 seconds together and buzzer will beep to release to locking. But cut off the power supply , the kid's protection is also release to locking. The kid's protection will not be cancelled after all procedures are completed.

- Power off Memory

For the convenience of the users, this program remember the washing program and function that is the choice of the users at the last time. The next time when selecting the program Mem this machine will run the program of your memory automatically.

- Suppression of the acoustic signals

This is an additional buzzer function on your appliance. After deactivating the buzzer function, the buzzer will be closed.

After starting the machine, press the "Temp" button for 3 seconds and you will hear a beep, then the buzzer will be closed. To restart the buzzer function, press the "Temp" button again for 3 seconds. The setting will be kept until the next reset.

Warning: After deactivating the buzzer function, the sounds will not be activated any more.

- Bubble Removal Function

Bubble Check Function: Redundant bubbles will occur when there is excessive detergent, which will affect wash and rinse effects. The procedure will check automatically and one bubble removal procedure will be added automatically to remove bubbles when excessive bubbles are checked.

WASHING PROCEDURES

Procedure Description	Load(kg)		Detergent Box			Default Temp.(°C) 6.0/7.5	Default Time (Min)		Default Speed (rpm)	
	6.0	7.5	Case I	Case II	Softener Case		6.0 1200	7.5 1400	1200	1400
Cotton Intensive	6.0	7.5	×	●	○	40	1:58	1:58	1000	1000
Cotton 60°	6.0	7.5	×	●	○	60	4:36	4:41	1200	1400
Cotton 40°	6.0	7.5	×	●	○	40	1:25	1:25	1200	1400
Cotton 20°	6.0	7.5	×	●	○	20	1:13	1:13	1000	1000
Quick 15'	2.0	2.0	×	●	○	Cold	0:15	0:15	800	800
Eco Wash	2.0	2.0	×	●	○	30	1:06	1:06	800	800
Rinse&Spin	6.0	7.5	×	×	○	—	0:31	0:31	1000	1000
Baby Care	6.0	7.5	×	●	○	60	1:39	1:39	1000	1000
Sports	3.0	3.5	×	●	○	40	1:19	1:19	800	800
Synthetic	3.0	3.5	×	●	○	40	1:33	1:33	1200	1200
Mixed	6.0	7.5	×	●	○	40	1:13	1:13	1000	1000
Delicate	2.5	2.5	×	●	○	30	1:00	1:00	600	600
Wool	2.0	2.0	×	●	○	40	1:06	1:06	400	400
Drain Only	—	—	×	×	×	—	0:01	0:01	0	0
Spin Only	6.0	7.5	×	×	×	—	0:12	0:12	1000	1000

- Means must
- Means optional
- ×

Notes

The parameters in this table are only for user's reference. The actual parameters maybe different with the parameters in table on the left.

Energy test program: Cotton 60° C, Speed: the highest speed;
Other as the default. Half load for 6.0/7.5Kg machine:3.0kg/3.75Kg.

"Cotton 60" are the "standard cotton 60" program and the standard washing programs to which the information in the label and the fiche relates, and they are suitable to clean normally soiled cotton laundry and that they are the most efficient programmes in terms of combined energy and water consumptions for washing that type of cotton laundry, that the actual water temperature may differ from the declared cycle temperature.

Maintenance

Before your maintenance starts, please do pull out the power plug or disconnect power and close the tap.

WARNING

- Solvents are forbidden to avoid that the washing machine is damaged, and toxic gases are generated or exploded.
- Never use water to sprinkle and wash the washing machine.
- It is forbidden that the detergents containing PCMX are used to clean the washing machine.

■ **Cleaning and Maintenance of Washing Machine Cabinet**

Proper maintenance on the washing machine can extend its working life. The surface can be cleaned with diluted non-abrasive neutral detergents when necessary. If there is any water overflow, use the wet cloth to wipe it off immediately. No sharp items are allowed to strike the cabinet.

Notes: formic acid and its diluted solvents or equivalent are forbidden.

■ **Clean Internal Drum**

The rusts left inside the drum by the metal articles shall be removed immediately with chlorine-free detergents.

Never use steel wool.

■ **Dispose a Frozen Washing Machine**

When the temperature drops below zero and your washing machine gets frozen, you may:

1. Disconnect the power supply for the washing machine.
2. Wash the tap with warm water to loosen inlet pipe.
3. Take down inlet pipe and immerse it in warm water.
4. Pour warm water into washing drum and wait for 10 minutes.
5. Reconnect inlet pipe to the tap and check whether inlet and outlet are working normally.

Notes: when the washing machine is reused, make sure the ambient temperature is above 0°C

■ **Anti-freeze**

If your washing machine is located in the room where it can get frozen easily, please drain the remaining water inside drain pipe and inlet pipe thoroughly.

Remove the remaining water in inlet pipe:

1. Close the tap.
2. Screw off the inlet pipe from tap and put its end into the container.
3. Start up any procedure except single Wash or Drain procedure. Water will be drained out of inlet pipe if any for about 40 seconds.
4. Reconnect the inlet pipe to tap.

Remove the remaining water in drain pump

WARNING

To avoid burning, it shall be done after the hot water inside the machine cools down.

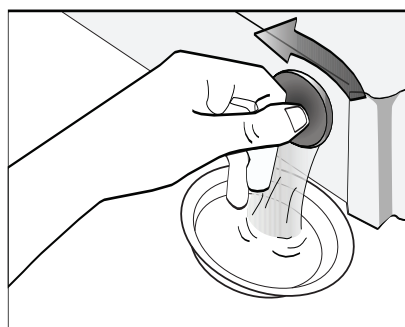

■ Clean detergent box and grooves

Clean detergent drawer and grooves

1. Press down the arrow location on softener cover inside the drawer.
2. Lift the clip up and take out softener cover and wash all grooves with water.
3. Restore the softener cover and push the drawer into position.

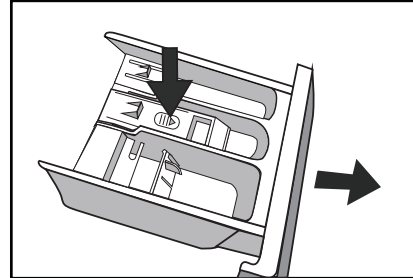

■ Clean inlet filter

Inlet filter shall must be cleaned if there is not any or insufficient water in when the tap is opened.

Clean the tap filter:

1. Close the tap.
2. Select any procedure except "Wash" or "Drain" procedure.
3. Press the button "Start/Pause" and keep the procedure running for about 40 seconds.
4. Remove the inlet pipe from the tap.
5. Use water to wash the filter.
6. Reconnect the inlet pipe.

Washing the filter in washing machine:

1. Screw off the inlet pipe from the backside of the machine.
2. Pull out the filter with long nose pliers and reinstall it back after being washed.
3. Reconnect the inlet pipe.
4. Open the tap and make sure there is no water leakage.
5. Close the tap.

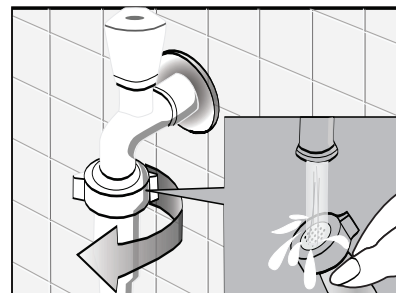
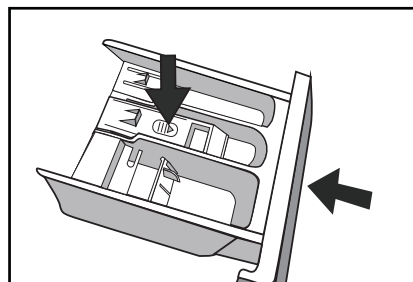
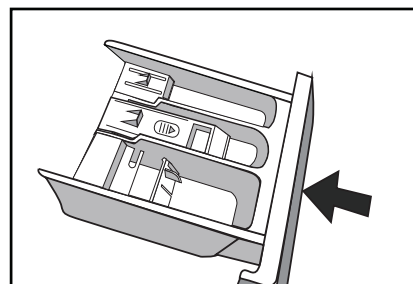

Notes: Generally, the tap filter is washed first and then the filter in washing machine will be washed. If only the filter in washing machine is washed, then the steps 1~3 in cleaning the tap filter shall be repeated.

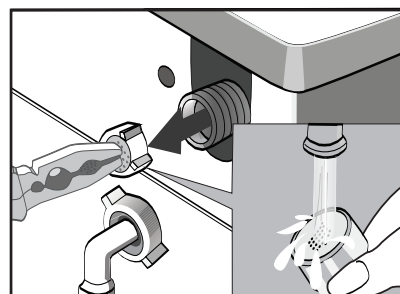
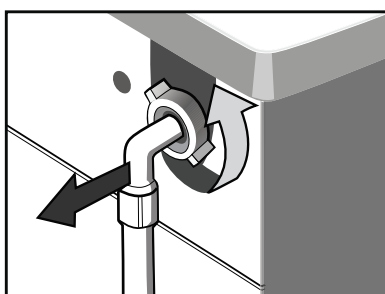

⚠ WARNING

Pull out the power plug to avoid electrical shock before washing.

After using the washing machine, pull out the power cord and close the door tightly to avoid pinching the kids.

■ Remove foreign matters**Drain Pump Filter:**

Drain pump filter can filter the yarns and small foreign matters from the washings.

Clean the filter periodically to ensure the normal operation of washing machine.

⚠ WARNING

According to the soil level within the cycles and the frequency of the cycles, you have to inspect and clean the filter regularly.

The pump should be inspected if the machine does not empty and/or spin;

The machine makes an unusual noise during draining due to objects such as safety pins, coins etc. blocking the pump.

The Service_panel proceed as follows:

1. After the power is disconnected, use hand to open the filter cover.

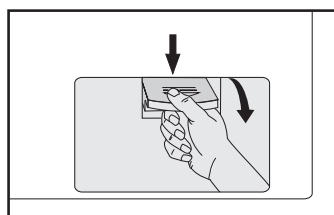

2. Turn the filter down as shown with the figure and take out sundries matters.

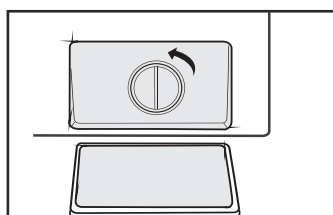

3. Reinstall each part back after sundries matters are removed.

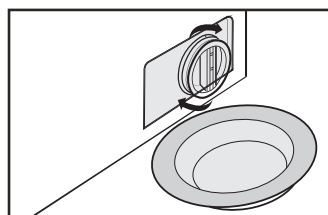
**Warning!**

When the appliance is in use and depending on the programme selected there can be hot water in the pump. Never remove the pump cover during a wash cycle, always wait until the appliance has finished the cycle, and is empty. When replacing the cover, ensure it is securely retight end so.

Troubleshooting

Troubles	Reason	Solution
Washing machine cannot start up		<p>Check if the door is closed tightly.</p> <p>Check if power plug is inserted well.</p> <p>Check if water supply tap is opened.</p> <p>Check if button "Start/Pause" is pressed.</p> <p>Check if button "On/Off" is pressed.</p>
Door cannot be opened	Machine's safety protection design is working.	Disconnect the power.
Heating fault	NTC is damaged and heating pipe is aging.	<p>Can normally wash the clothes.</p> <p>Only cannot wash with heating.</p> <p>Shall contact the service center promptly.</p>
Water leakage	The connection between inlet pipe or outlet hose and tap or washing machine is not tight. Drain pipe in the room is blocked.	<p>Check and fasten water pipes.</p> <p>Clean up outlet hose and ask a specialized person to repair it when necessary.</p>
Water is overflowed from the bottom of the machine	The inlet pipe is not connected firmly. Outlet hose has water leakage.	<p>Fix the inlet pipe.</p> <p>Replace the drain hose.</p>
Indicator or display does not light.	Power is disconnected. PC board has problems. Harness has connection problem.	<p>Check if the power is shut down and power plug is connected correctly.</p> <p>If not, please call up service line.</p>
Detergent residues in the box	Washing powder is dampened and agglomerated.	<p>Clean and wipe the box.</p> <p>Use liquid detergents or the detergents special for drum.</p>
Washing effects are not good	The clothes are too dirty. Insufficient detergent quantity.	<p>Select a proper procedure.</p> <p>Add the proper detergent quantity according to the instructions in detergent package.</p>
Abnormal noise Great vibration		<p>Check if the fixing (bolts) has been removed. If cabinet is installed on the solid and level floor.</p> <p>Check if there are any barrettes or metal articles inside.</p> <p>Check if the legs in the washing machine are adjusted level.</p>

Display LED	Description	Reason	Solution
<i>E30</i>	Door lock problem	Door is not closed properly.	Restart after the door is closed.
		Please call up service line if there are still troubles.	
<i>E10</i>	Water injecting problem while washing	Tap is not opened or water flows too slowly. Inlet valve filter is blocked. Inlet pipe is twisted. If water is not supplied	Open the tap or wait till the water supply becomes normal. Check inlet valve filter. Straighten the water pipe Check the other taps in the room.
		Please call up service line if there are still troubles.	
<i>E21</i>	Drain problem while washing	Outlet hose is blocked or twisted Drain pump is blocked	Wash and straighten outlet hose. Wash drain pump filter
		Please call up service line if there are still troubles.	
Please call up the service line if there is any other problem.			











Technical Data

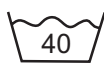









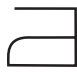

Parameter	
Washing Capacity	7.5kg
Dimension(W*D*H)	595*565*850
Net Weight	68kg
Rated Power	2000W
Power Supply	220-240V~,50Hz
MAX.Current	10A
Standard Water Pressure	0.05MPa~1MPa





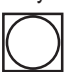



Appendix

■ Care Lable

The label and sign on the fabric can help you to choose the best way to launder your clothes.

<p>Normal wash</p>  <p>Gentle wash</p> 	 <p>Warm wash (max 40°C)</p>	<p>Hand wash</p>  <p>Do not wash</p> 	<p>Bleach</p>  <p>Do not bleach</p> 	<p>Chlorine bleach may be used</p>  <p>Chlorine bleach not be used</p> 	<p>Tumble dry. Medium (max 150°C)</p>  <p>Tumble dry. Low heat (max 110°C)</p> 
---	--	---	--	---	--

<p>Iron</p>  <p>Do not iron</p> 	<p>Cool iron(max 110 °C)</p>  <p>Warm iron.medium (max 150°C)</p> 	<p>Dry clean</p>  <p>Do not dry clean</p> 	<p>Dry clean normal cycle with any solvent</p>  <p>Dry clean normal cycle petroleum solvent only</p> 	<p>Tumble dry normal</p>  <p>Dry flat</p> 	<p>Drip dry</p>  <p>Hang to dry /Line dry</p> 
---	--	---	--	---	---

<p>Iron with cloth</p>  <p>Steam Iron</p> 	<p>Dry after wash</p>  <p>Line Dry in shade</p> 	<p>Warmly dry clean</p>  <p>Do not tumble dry</p> 	<p>Line Dry</p> 	<p>No Wring</p> 	<p>No machine wash</p> 
--	--	--	---	--	--

Electrical Warning

To avoid fire,electrical shock and other accidents,please remember the following reminding:

- Only the voltage indicated in power label can be used. If you are not clear of the voltage at home, please contact the local power bureau.
- When you are using the heating function, the maximum current through the washing machine will reach 10A. Therefore, please make sure the power supply units (current, voltage and cable) can meet the normal load requirements for the machine.
- Protect the power cord properly. Power cord shall be fixed well so that it will not trip the people or other things and be damaged. Special attention shall be paid to the socket. It shall be plugged into the sockets easily and attention shall be paid to the plug location.
- Do not make the wall-mounted socket overloaded or cable extended. Overloading of the wiring may cause fire or electrical shock. Do not pull out power plug with wet hand.
- To ensure your safety, power plug shall be inserted into an earthed three-pole socket. Carefully check and ensure that your socket is properly and reliably earthed.

Attach your receipt to this page



ADDITIONAL INFORMATION FOR STANDARD PERFORMANCE TESTING

(AS/NZS 2040.1:2005+Amdt1-2007+Amdt2-2009)

1. Water connections: Cold & hot water connection
2. Water supply pressure: 320 kPa
3. Warm wash Program: Cotton 60° C Display: 4:36
Cold wash program: Cotton Cold(no temperature display is cold wash)
4. Detergent type: Drum detergent
5. Detergent quantity: Default
6. Adding detergent:
The detergent is dissolved and added as Paragraph B7.3 of AS/NZS 2040.1
The detergent shall be dissolved in 1 L of water
7. Anti-sudsing agent: Max
8. Test load mass: 6.0kg
9. Water consumption: 61L
10. Test Voltage:220-240V~,50Hz

1. Water connections: Cold & hot water connection
2. Water supply pressure: 320 kPa
3. Warm wash Program: Cotton 60° C Display: 4:41
Cold wash program: Cotton Cold(no temperature display is cold wash)
4. Detergent type: Drum detergent
5. Detergent quantity: Default
6. Adding detergent:

The detergent is dissolved and added as Paragraph B7.3 of AS/NZS 2040.1

- The detergent shall be dissolved in 1 L of water
7. Anti-sudsing agent: Max
 8. Test load mass: 7.5kg
 9. Water consumption: 77L
 10. Test Voltage:220-240V~,50Hz

Purchase Details

For future reference, please record the following information which can be found on the rating plate and the date of purchase which can be found on your sales invoice.

The rating plate of your hob is located on the underneath of the appliance. Therefore please fit the duplicate data plates or label on the outside of the cupboard to sure that the label can be easily seen during operation.

STORE DETAILS

STORE NAME | _____

ADDRESS | _____

TELEPHONE | _____ PURCHASE DATE | _____

PRODUCT DETAILS

MODEL NO. | _____

SERIAL NO.* | _____

Warranty Information

WARRANTY TERMS & CONDITIONS WASHING MACHINES & CLOTHES DRYERS

This document sets out the terms and conditions of the product warranties for Residentia Group Appliances. It is an important document. Please keep it with your proof of purchase documents in a safe place for future reference should you require service for your Appliance.

1. **IN THIS WARRANTY**
 - (a) 'acceptable quality' as referred to in clause 10 of this warranty has the same meaning referred to in the ACL;
 - (b) 'ACL' means Trade Practices Amendment (Australian Consumer Law) Act (No.2) 2010;
 - (c) 'Appliance' means any Residentia Group product purchased by you accompanied by this document;
 - (d) 'ASR' means Residentia Group authorised service representative;
 - (e) 'Residentia Group' means Residentia Group Pty Ltd of 165 Barkly Ave, Burnley VIC 3121, ACN 600 546 656 in respect of Appliances purchased in Australia;
 - (f) 'major failure' as referred to in clause 10 of this warranty has the same meaning referred to in the ACL and includes a situation when an Appliance cannot be repaired or it is uneconomic for Residentia Group, at its discretion, to repair an Appliance during the Warranty Period;
 - (g) 'Warranty Period' means:
 - (i) where the Appliance is used for personal, domestic or household use (i.e. normal single family use) as set out in the instruction manual, the Appliance is warranted against manufacturing defects for 24 months, following the date of original purchase of the Appliance;
 - (h) 'you' means the purchaser of the Appliance not having purchased the Appliance for re-sale, and 'your' has a corresponding meaning.
2. This warranty only applies to Appliances purchased and used in Australia and is in addition to (and does not exclude, restrict, or modify in any way) any non-excludable statutory warranties in Australia.
3. During the Warranty Period Residentia Group or its ASR will, at no extra charge if your Appliance is readily accessible for service, without special equipment and subject to these terms and conditions, repair or replace any parts which it considers to be defective. Residentia Group or its ASR may use remanufactured parts to repair your Appliance. You agree that any replaced Appliances or parts become the property of Residentia Group. This warranty does not apply to light globes, batteries, filters or similar perishable parts.
4. Parts and Appliances not supplied by Residentia Group are not covered by this warranty.

5. You will bear the cost of transportation, travel and delivery of the Appliance to and from Residentia Group or its ASR. If you reside outside of the service area, you will bear the cost of:
- (a) travel of an authorised representative;
 - (b) transportation and delivery of the Appliance to and from Residentia Group or its ASR, in all instances, unless the Appliance is transported by Residentia Group or its ASR, the Appliance is transported at the owner's cost and risk while in transit to and from Residentia Group or its ASR.
6. Proof of purchase is required before you can make a claim under this warranty.
7. You may not make a claim under this warranty unless the defect claimed is due to faulty or defective parts or workmanship. Residentia Group is not liable in the following situations (which are not exhaustive):
- (a) the Appliance is damaged by:
 - (i) accident
 - (ii) misuse or abuse, including failure to properly maintain or service
 - (iii) normal wear and tear
 - (iv) power surges, electrical storm damage or incorrect power supply
 - (v) incomplete or improper installation
 - (vi) incorrect, improper or inappropriate operation
 - (vii) insect or vermin infestation
 - (viii) failure to comply with any additional instructions supplied with the Appliance;
 - (b) the Appliance is modified without authority from Residentia Group in writing;
 - (c) the Appliance's serial number or warranty seal has been removed or defaced;
 - (d) the Appliance was serviced or repaired by anyone other than Residentia Group, an authorised repairer or ASR.
8. This warranty, the contract to which it relates and the relationship between you and Residentia Group are governed by the law applicable where the Appliance was purchased.
9. To the extent permitted by law, Residentia Group excludes all warranties and liabilities (other than as contained in this document) including liability for any loss or damage whether direct or indirect arising from your purchase, use or non use of the Appliance.
10. For Appliances and services provided by Residentia Group in Australia, the Appliances come with a guarantee by Residentia Group that cannot be excluded under the Australian Consumer Law. You are entitled to a replacement or refund for a major failure and for compensation for any other reasonably foreseeable loss or damage. You are also entitled to have the Appliance repaired or replaced if the Appliance fails to be of acceptable quality and the failure does not amount to a major failure. The benefits to you given by this warranty are in addition to your other rights and remedies under a law in relation to the Appliances or services to which the warranty relates.
11. At all times during the Warranty Period, Residentia Group shall, at its discretion, determine whether repair, replacement or refund will apply if an Appliance has a valid warranty claim applicable to it.
12. Missing parts are not covered by warranty. Residentia Group reserves the right to assess each request for missing parts in a case by case basis. Any parts that are not reported missing in the first week after purchase will not provide free of charge.
13. To enquire about claiming under this warranty, please follow these steps:
- (a) carefully check the operating instructions, user manual and the terms of this warranty;
 - (b) have the model and serial number of the Appliance available;
 - (c) have the proof of purchase (e.g. an invoice) available;
 - (d) telephone the numbers shown below.
14. You accept that if you make a warranty claim, Residentia Group and its ASR may exchange information in relation to you to enable Residentia Group to meet its obligations under this warranty.

IMPORTANT

Before calling for service, please ensure that the steps in point 13 have been followed.

→ Service: Please call 1300 11 HELP (4357)

The Australian Consumer Law requires the inclusion of the following statement with this warranty:

Our goods come with guarantees that cannot be excluded under the Australian Consumer Law. You are entitled to a replacement or refund for a major failure and for compensation for any other reasonably foreseeable loss or damage. You are also entitled to have the goods repaired or replaced if the goods fail to be of acceptable quality and the failure does not amount to a major failure.

This page
is intentionally
left blank

This page
is intentionally
left blank



E2447

Esatto Appliances Exactly what you need



RESIDENTIA
GROUP